

FORM OF CERTIFICATE OF SERVICE OF NOTICE OF APPLICATION FOR
MODIFICATION ORDER

WILDLIFE AND COUNTRYSIDE ACT 1981

EAST SUSSEX COUNTY COUNCIL DEFINITIVE MAP AND STATEMENT

CERTIFICATE OF SERVICE OF NOTICE OF APPLICATION FOR MODIFICATION ORDER

To: East Sussex County Council
of: County Hall, St. Anne's Crescent

I Christopher Smith, for and on behalf of the Ramblers Association, of 2nd Floor Camelford House, 87-90 Albert Embankment London SE1 hereby certify that the requirements of paragraph 2 of Schedule 14 to the Wildlife and Countryside Act 1981 have been complied with.

Signed:

Dated: 3/12/16.....

A large black rectangular redaction covers the signature of Christopher Smith.

Application Lewes B

WILDLIFE AND COUNTRYSIDE ACT 1981

THE DEFINITIVE MAP AND STATEMENT OF PUBLIC RIGHTS OF WAY IN EAST
SUSSEX

To East Sussex County Council

Of County Hall, St Anne's Crescent, Lewes

I Christopher Smith, for and on behalf of the Ramblers Association, of 2nd Floor Camelford House, 87-90 Albert Embankment London SE1 7TW hereby apply for an order under section 53(2) of the Wildlife and Countryside Act 1981 modifying the definitive map and statement for the area by:

Adding the bridleway from bridleway Lewes 7b at point A (Grid reference 540304 109540) to point B on bridleway Lewes 8b (grid reference 540300 109528) and shown on the map accompanying this application.

I attach copies of the following documentary evidence (including statements of witnesses) in support of this application:

- 21 statements of witnesses
- Applicant's Statement

Signed 

Dated 2/12/16

Applicant's reference: Lewes B

1
2
3
4
5
6
7
8
9
10
11
12
13
14
15
16
17
18
19
20
21
22
23
24
25
26
27
28
29
30
31
32
33
34
35
36
37
38
39
40
41
42
43
44
45
46
47
48
49
50
51
52
53
54
55
56
57
58
59
60
61
62
63
64
65
66
67
68
69
70
71
72
73
74
75
76
77
78
79
80
81
82
83
84
85
86
87
88
89
90
91
92
93
94
95
96
97
98
99
100

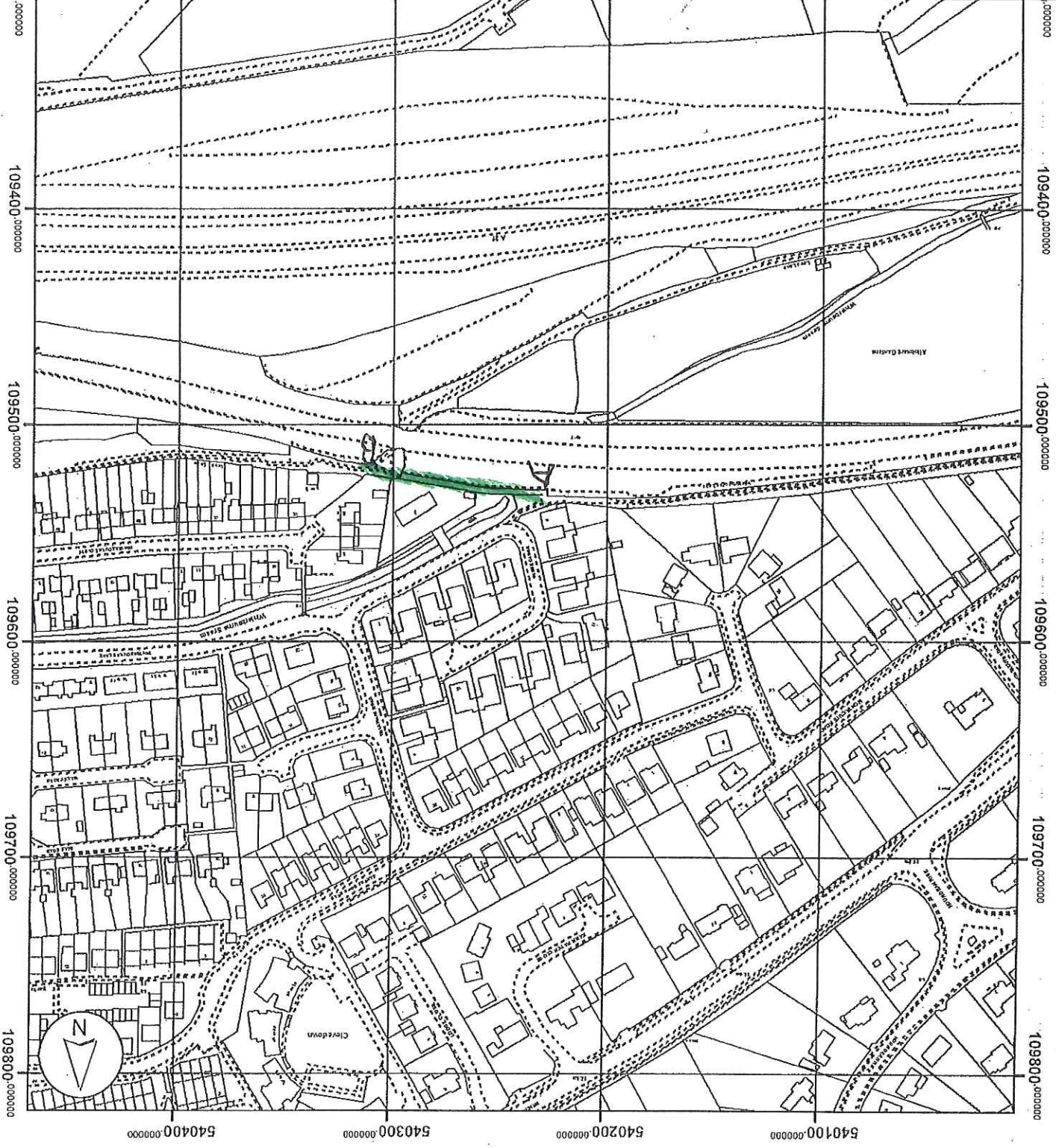

109800.000000

109400.000000

109500.000000

109600.000000

109700.000000

109800.000000

540400.000000

540300.000000

540200.000000

540100.000000

109800.000000

109400.000000

109500.000000

109600.000000

109700.000000

109800.000000