

WILDLIFE AND COUNTRYSIDE ACT 1981  
FORM OF APPLICATION FOR MODIFICATION ORDER

To: East Sussex County Council  
of: County Hall, St. Anne's Crescent

I/We, [name of applicant Mary Parker]  
of [address of applicant Cattinghams, East Chilmington, BN7 3DT]  
hereby apply for an order under section 53(2) of the Wildlife and Countryside Act 1981  
modifying the definitive map and statement for the area by

[deleting the [footpath] [bridleway] [byway open to all traffic] from Barcombe Hills Rd. TQ 433 147  
to .....

[adding the [footpath] [bridleway] [byway open to all traffic] from Barcombe Mills Rd. TQ 433 147  
to Wickham road of HAINES LANE TQ 432 149 AND Byway Barcombe 25A  
[[upgrading] [downgrading] to a [footpath] [bridleway] [byway open to all traffic] the [footpath]  
[bridleway] [byway open to all traffic] from .....



to .....  
[[varying] [adding to] the particulars relating to the [footpath] [bridleway] [byway open to all  
traffic] from ..... to ..... by making the following [variations]  
[additions].....]  
and shown on the map accompanying this application.

I/We attach copies of the following documentary evidence (including statements of  
witnesses) in support of this application:

Signed: ..  

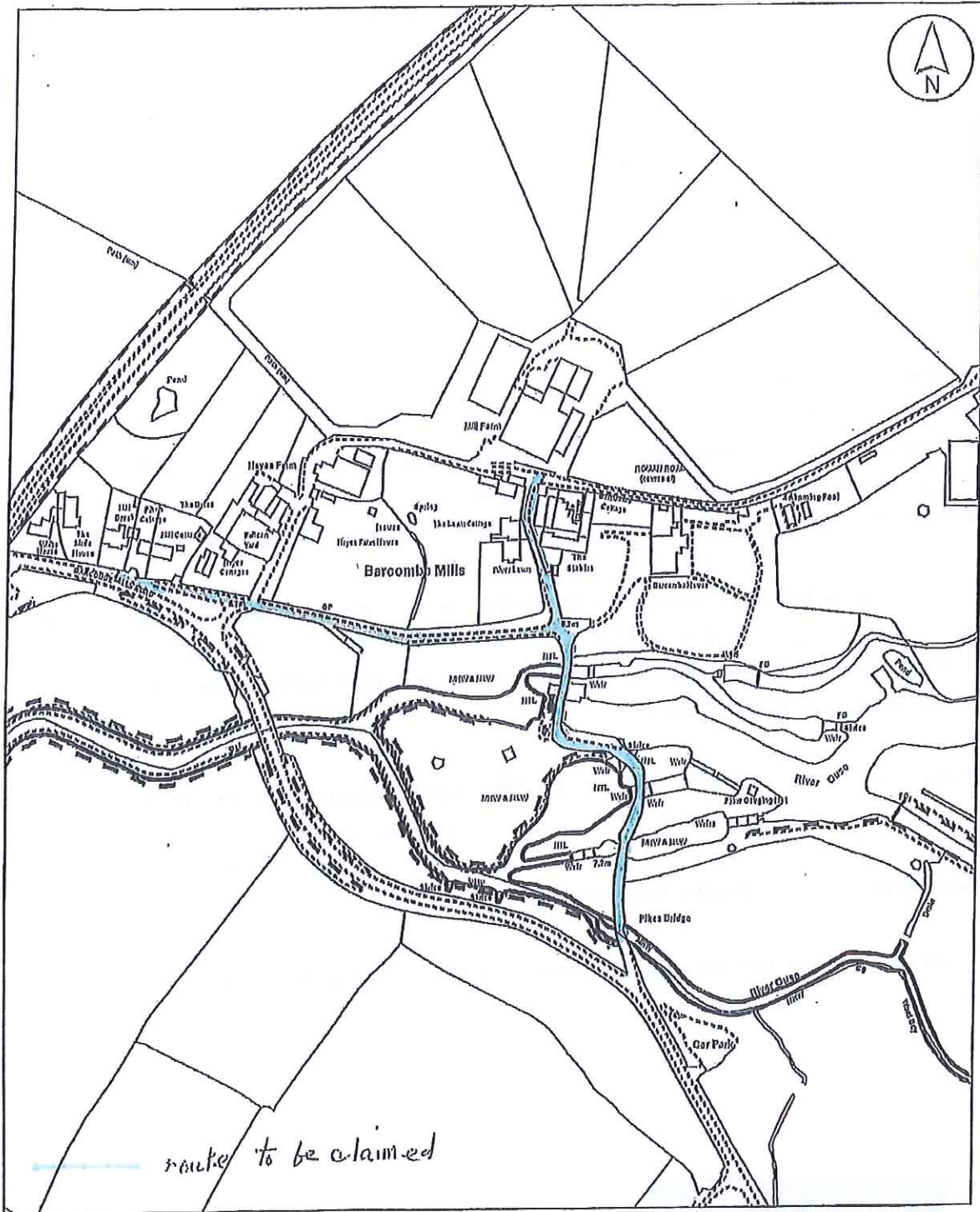
Dated: 7.2.18



Map Title: Barcombe Mills area		East Sussex County Council County Hall St Annes Crescent Lewes 	
Key:			
Date:	28/11/2017	Map No:	
Scale:	1:3,061	Author:	SJK

© East Sussex County Council 2017.  
 Aerial Photography © Ordnance Survey 2017.  
 This map is reproduced from Ordnance Survey material with the permission of Ordnance Survey in which they have copyright and in which their names and any other marks or designations are used. Unauthorised reproduction by any person is prohibited and may lead to prosecution at the discretion of the Crown copyright and may lead to prosecution at the discretion of the Crown copyright, 100019101, 2017.

Appendix 2

FORM OF NOTICE OF APPLICATION FOR MODIFICATION ORDER  
SECTION 53(5) OF, AND SCHEDULE 14 TO, THE WILDLIFE AND COUNTRYSIDE ACT 1981  
EAST SUSSEX COUNTY COUNCIL DEFINITIVE MAP AND STATEMENT

To: [name of owner/occupier XXXXXXXXXX  
of: [address of owner/occupier .....Old Mill Bungalow, Barcombe Mills, E.Sx.

I, Mary Parker.....]  
of: Cottinghams, East Chiltington, ...East Sussex, BN7 3QT....]  
hereby give notice that on 2nd February, 2018 I made application to the East Sussex County Council of County Hall, St. Anne's Crescent, Lewes, East Sussex that the definitive map and statement for the area be modified by  
adding the bridleway from Barcombe Mills Road (OS map ref:TQ433148).....  
to western end of Hayes Lane  
and  
to Byway ...Barcombe 25a.....]

Signed:

Dated: 22nd February 2018.....

Appendix 2

FORM OF NOTICE OF APPLICATION FOR MODIFICATION ORDER  
SECTION 53(5) OF, AND SCHEDULE 14 TO, THE WILDLIFE AND COUNTRYSIDE ACT 1981  
EAST SUSSEX COUNTY COUNCIL DEFINITIVE MAP AND STATEMENT

To: [name of owner/occupier The Occupier

of: [address of owner/occupier .....Lawn Cottage, Barcombe Mills, E.Sx.

I, Mary Parker.....]

of: Cottinghams, East Chilington, ...East Sussex, BN7 3QT....]

hereby give notice that on 2nd February, 2018 I made application to the East Sussex County Council of County Hall, St. Anne's Crescent, Lewes, East Sussex that the definitive map and statement for the area be modified by

adding the bridleway from Barcombe Mills Road (OS map ref:TQ433148).....

to western end of Hayes Lane

and

to Byway ...Barcombe 25a.....]

Signed:

Dated: 22nd February 2018.....

Appendix 2

FORM OF NOTICE OF APPLICATION FOR MODIFICATION ORDER  
SECTION 53(5) OF, AND SCHEDULE 14 TO, THE WILDLIFE AND COUNTRYSIDE ACT 1981  
EAST SUSSEX COUNTY COUNCIL DEFINITIVE MAP AND STATEMENT

To: [name of owner/occupier ..... 

of: [address of owner/occupier ..... The Stables, Barcombe Mills, E.Sx.

I, Mary Parker.....]

of: Cottinghams, East Chilington, ...East Sussex, BN7 3QT....]

hereby give notice that on 2nd February, 2018 I made application to the East Sussex County Council of County Hall, St. Anne's Crescent, Lewes, East Sussex that the definitive map and statement for the area be modified by

adding the bridleway from Barcombe Mills Road (OS map ref:TQ433148).....

to western end of Hayes Lane

and

to Byway ...Barcombe 25a.....]

Signed:

Dated: 22nd February 2018.....

Appendix 2

FORM OF NOTICE OF APPLICATION FOR MODIFICATION ORDER  
SECTION 53(5) OF, AND SCHEDULE 14 TO, THE WILDLIFE AND COUNTRYSIDE ACT 1981  
EAST SUSSEX COUNTY COUNCIL DEFINITIVE MAP AND STATEMENT

To: [name of owner/occupier ..... The Occupier

of: [address of owner/occupier ..... River Lawn, Barcombe Mills, E.Sx.

[, Mary Parker.....]

of: Cottinghams, East Chiltington, ... East Sussex, BN7 3QT....]

hereby give notice that on 2nd February, 2018 I made application to the East Sussex County Council of County Hall, St. Anne's Crescent, Lewes, East Sussex that the definitive map and statement for the area be modified by

adding the bridleway from Barcombe Mills Road (OS map ref:TQ433148).....

to western end of Hayes Lane

and

to Byway ... Barcombe 25a.....]

Signed:

Dated: 22nd February 2018.....

Appendix 2

FORM OF NOTICE OF APPLICATION FOR MODIFICATION ORDER  
SECTION 53(5) OF, AND SCHEDULE 14 TO, THE WILDLIFE AND COUNTRYSIDE ACT 1981  
EAST SUSSEX COUNTY COUNCIL DEFINITIVE MAP AND STATEMENT

To: [name of owner/occupier XXXXXXXXXX]  
of: [address of owner/occupier .....Hayes Farmhouse, Barcombe Mills, E.Sx.

I, Mary Parker.....]  
of: Cottinghams, East Chiltington, ...East Sussex, BN7 3QT....]  
hereby give notice that on 2nd February, 2018 I made application to the East Sussex County Council of County Hall, St. Anne's Crescent, Lewes, East Sussex that the definitive map and statement for the area be modified by  
adding the bridleway from Barcombe Mills Road (OS map ref:TQ433148).....  
to western end of Hayes Lane  
and  
to Byway ...Barcombe 25a.....]

Signed:

Dated: 22nd February 2018.....

Appendix 2

FORM OF NOTICE OF APPLICATION FOR MODIFICATION ORDER  
SECTION 53(5) OF, AND SCHEDULE 14 TO, THE WILDLIFE AND COUNTRYSIDE ACT 1981  
EAST SUSSEX COUNTY COUNCIL DEFINITIVE MAP AND STATEMENT

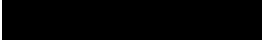
To: [name of owner/occupier ..... 

of: [address of owner/occupier ..... Barcombe House, Barcombe Mills, E.Sx.

I, Mary Parker.....]

of: Cottinghams, East Chiltington, ...East Sussex, BN7 3QT...]

hereby give notice that on 2nd February, 2018 I made application to the East Sussex County Council of County Hall, St. Anne's Crescent, Lewes, East Sussex that the definitive map and statement for the area be modified by

adding the bridleway from Barcombe Mills Road (OS map ref:TQ433148).....

to western end of Hayes Lane

and

to Byway ...Barcombe 25a.....]

Signed:



Dated: 22nd February 2018.....



Appendix 2

FORM OF NOTICE OF APPLICATION FOR MODIFICATION ORDER  
SECTION 53(5) OF, AND SCHEDULE 14 TO, THE WILDLIFE AND COUNTRYSIDE ACT 1981  
EAST SUSSEX COUNTY COUNCIL DEFINITIVE MAP AND STATEMENT

To: [name of owner/occupier The Occupier  
of: [address of owner/occupier .....New Mill House, Barcombe Mills, E.Sx.

I, Mary Parker.....]  
of: Cottinghams, East Chiltington, ...East Sussex, BN7 3QT...]  
hereby give notice that on 2nd February, 2018 I made application to the East Sussex County Council of County Hall, St. Anne's Crescent, Lewes, East Sussex that the definitive map and statement for the area be modified by  
adding the bridleway from Barcombe Mills Road (OS map ref:TQ433148).....  
to western end of Hayes Lane  
and  
to Byway ...Barcombe 25a.....]

Signed:



Dated: 22nd February 2018.....

Appendix 2

FORM OF NOTICE OF APPLICATION FOR MODIFICATION ORDER  
SECTION 53(5) OF, AND SCHEDULE 14 TO, THE WILDLIFE AND COUNTRYSIDE ACT 1981  
EAST SUSSEX COUNTY COUNCIL DEFINITIVE MAP AND STATEMENT

To: [name of owner/occupier ..... 

of: [address of owner/occupier ..... The Barn, Barcombe Mills, E.Sx.

I, Mary Parker.....]

of: Cottinghams, East Chiltington, ...East Sussex, BN7 3QT...]

hereby give notice that on 2nd February, 2018 I made application to the East Sussex County Council of County Hall, St. Anne's Crescent, Lewes, East Sussex that the definitive map and statement for the area be modified by

adding the bridleway from Barcombe Mills Road (OS map ref:TQ433148).....

to western end of Hayes Lane

and

to Byway ... Barcombe 25a.....]

Signed: 

Dated: 22nd February 2018.....

Appendix 2

FORM OF NOTICE OF APPLICATION FOR MODIFICATION ORDER  
SECTION 53(5) OF, AND SCHEDULE 14 TO, THE WILDLIFE AND COUNTRYSIDE ACT 1981  
EAST SUSSEX COUNTY COUNCIL DEFINITIVE MAP AND STATEMENT

To: Environment Agency

of: Customers & Engagement, Solent and South Downs Area, Environment Planning and  
Engagement, Environment Agency, Guildbourne House, Chatsworth Road, Worthing, West Sussex  
BN11 1LD

I, Mary Parker.....]

of: Cottinghams, East Chiltington, ... East Sussex, BN7 3QT....]

hereby give notice that on 2nd February, 2018 I made application to the East Sussex County  
Council of County Hall, St. Anne's Crescent, Lewes, East Sussex that the definitive map and  
statement for the area be modified by

adding the bridleway from Barcombe Mills Road (OS map ref:TQ433148).....

to western end of Hayes Lane

and

to Byway ... Barcombe 25a.....]

Signed:

Dated: 15 March 2018

Appendix 2

FORM OF NOTICE OF APPLICATION FOR MODIFICATION ORDER  
SECTION 53(5) OF, AND SCHEDULE 14 TO, THE WILDLIFE AND  
COUNTRYSIDE ACT 1981  
EAST SUSSEX COUNTY COUNCIL DEFINITIVE MAP AND STATEMENT

To: owner/occupier

of: This land

I, Mary Parker.....

of: Cottinghams, East Chiltington, ...East Sussex, BN7 3QT....]

hereby give notice that on 2nd February, 2018 I made application to the  
East Sussex County Council of County Hall, St. Anne's Crescent, Lewes,  
East Sussex that the definitive map and statement for the area be modified by

adding the bridleway from Barcombe Mills Road (OS map ref:TQ433148).....  
to western end of Hayes Lane

and

to Byway ...Barcombe 25a.....]

Signed:

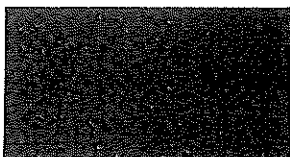

Dated: 29th March 2018.....

Appendix 2

FORM OF NOTICE OF APPLICATION FOR MODIFICATION ORDER  
SECTION 53(5) OF, AND SCHEDULE 14 TO, THE WILDLIFE AND COUNTRYSIDE ACT 1981  
EAST SUSSEX COUNTY COUNCIL DEFINITIVE MAP AND STATEMENT

To:



of: [2 Hayes Cottages, Barcombe Mills, East Sussex. BN8 5BP

I, Mary Parker.....]

of: Cottinghams, East Chiltington, ...East Sussex, BN7 3QT....]

hereby give notice that on 2nd February, 2018 I made application to the East Sussex County Council of County Hall, St. Anne's Crescent, Lewes, East Sussex that the definitive map and statement for the area be modified by

adding the bridleway from Barcombe Mills Road (OS map ref:TQ433148).....

to western end of Hayes Lane.

and

to Byway ... Barcombe 25a.....]

Signed:

Dated: 3<sup>rd</sup> May 2018.....

This notice delivered by hand.

Appendix 3

FORM OF CERTIFICATE OF SERVICE OF NOTICE OF APPLICATION FOR  
MODIFICATION ORDER

WILDLIFE AND COUNTRYSIDE ACT 1981

EAST SUSSEX COUNTY COUNCIL DEFINITIVE MAP AND STATEMENT

CERTIFICATE OF SERVICE OF NOTICE OF APPLICATION FOR MODIFICATION ORDER

To: East Sussex County Council

of: County Hall, St. Anne's Crescent

I, Mary Parker.....]

of, Cottinghams, East Chiltington, East Sussex. BN7 3QT.....]

hereby certify that the requirements of paragraph 2 of Schedule 14 to the Wildlife and  
Countryside Act 1981 have been complied with.

Signed: ..



Dated: 2nd April 2018.

Appendix 3

FORM OF CERTIFICATE OF SERVICE OF NOTICE OF APPLICATION FOR  
MODIFICATION ORDER

WILDLIFE AND COUNTRYSIDE ACT 1981

EAST SUSSEX COUNTY COUNCIL DEFINITIVE MAP AND STATEMENT

CERTIFICATE OF SERVICE OF NOTICE OF APPLICATION FOR MODIFICATION ORDER

To: East Sussex County Council

of: County Hall, St. Anne's Crescent

I, Mary Parker.....]

of, Cottinghams, East Chiltington, East Sussex. BN7 3QT.....]

hereby certify that the requirements of paragraph 2 of Schedule 14 to the Wildlife and  
Countryside Act 1981 have been complied with.

Signed: ...

Dated: 3rd May 2018.

